

# Master Controller

# MC 250

## Features

- Two parallel analogue output signals for speed and braking reference
- Emergency brake position
- Step less brake sector
- Spring back return to brake sector from full power
- Dead man "twist action"
- 15 digital signals for main handle positions. (Costing, traction, braking, emergency brake)
- Thumb operated switch in handle
- Ergonomic handle with palm rest
- IP class: IP65
- Side wall mounted

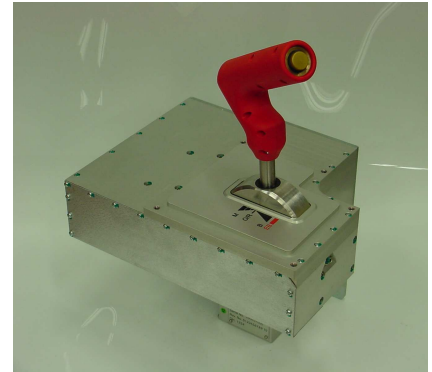

## Technical description

- Master Controller constructed by steel and aluminium parts surface treated for tough conditions.

## Technical data

- Power supply for analogue signals: DC 15V
- Weight: 10,4kg
- Analogues output level: 0,3 VDC- 9,7 VDC
- Electrical interface: WEAM male connector
- Operating angle: 68,5°

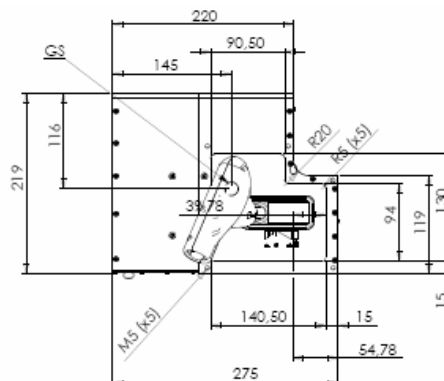
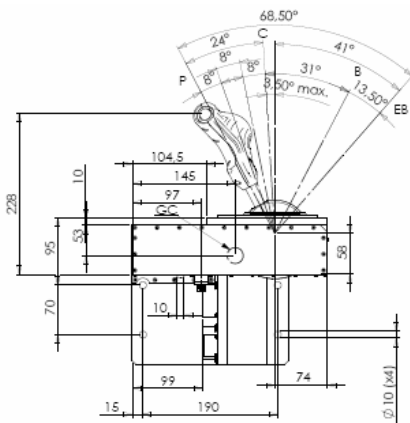

**AQ Mekatronik AB**

Phone: +46 278 322 50  
www.aqg.se

